

# TECHNICAL DATA SHEET

## WASAABII 2x1000LM SURFACE DUO IP20

INDOOR - INTERNO - INNERBEREICH - INTERIEUR - INTÉRIEUR - INTERIOR

Adjustable 0° - 80°

Surface mounted

Material: Aluminium



### Ref N° 1100 BLACK

Black  
Nero  
Schwarz  
Zwart  
Noir  
Negro



### Ref N° 1100 WHITE

White  
Bianco  
Weiß  
Wit  
Blanc  
Blanco



### Ref N° 1100 GREY

Grey  
Grigio  
Grau  
Grijs  
Gris  
Gris



### Ref N° 1100 MESSING

Brass  
Otonne  
Messing  
Messing  
Laiton  
Latón



### Ref N° 1100 BRONZE

Bronze  
Bronzo  
Bronze  
Bronz  
Bronze  
Bronze



### Ref N° 1101 00 001

Clip-on assessorly 1  
Small ball

### WASAABII SURFACE DUO 2x1000LM CRI 92 PHASE DIM

2700°K	3000°K
REF N° 1156 76 930	REF N° 1156 76 830

2x8,3W-2x1000LM-2stepMacAdam-**A+**  
Parallel wiring - 230VAC - - - -   
Integrated phase dimmable LED driver -  
Standard beam 28° - Optional 44° beam

### WASAABII SURFACE DUO 2x1000LM CRI 92 1-10V DIM

2700°K	3000°K
REF N° 1156 66 930	REF N° 1156 66 830

2x8,3W-2x1000LM-2stepMacAdam-**A+**  
Parallel wiring - 230VAC - - - -   
Integrated 1-10V dimmable LED driver -  
Standard beam 28° - Optional 44° beam

### WASAABII SURFACE DUO 2x1000LM CRI 92 DALI DIM

2700°K	3000°K
REF N° 1156 36 930	REF N° 1156 36 830

2x8,3W-2x1000LM-2stepMacAdam-**A+**  
Parallel wiring - 230VAC - - - -   
Integrated DALI dimmable LED driver -  
Standard beam 28° - Optional 44° beam

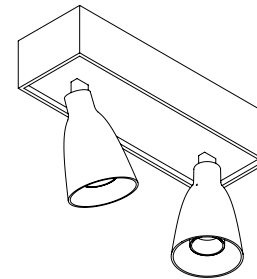
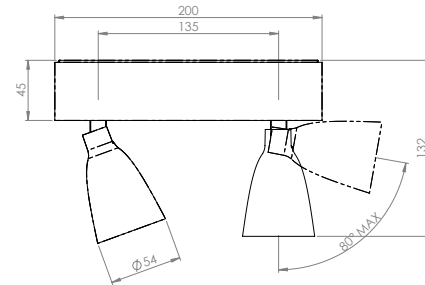
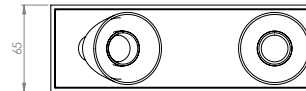

### BEAM ANGLES

**STANDARD** (included) beam angle 28°  
REF N° 203 20 044 (option) beam angle 44°